

THIS DRAWING ILLUSTRATES DESIGN STATUS ONLY.
AVAILABILITY OF PARTS SHALL OBTAINED FROM
ALLISON TRANSMISSION SALES AND THE ENGINE
MANUFACTURER.

FOR TRANSMISSION DRIVE DATA NOT SHOWN,
SEE DRAWING AS67-420.

FOR TRANSMISSION INSTALLATION DATA NOT SHOWN,
SEE BASIC INSTALLATION DRAWING.

BOLT TORQUES ARE 8% UNLESS OTHERWISE SPECIFIED

* DENOTES PARTS NOT SEPARATELY AVAILABLE

DIMENSIONS ARE FOR REFERENCE ONLY

TRANSMISSION ADAPTATION KIT-29537247

- *FLEXPLATE ADAPTER-29537246
- *12-BOLT-11505232

ENGINE ADAPTATION KIT-29557238

- *FLEXPLATE ASSEMBLY-29547731
- *3-FLEXPLATE-29547730
- *ADAPTER-HUB-29547732
- *PLATE-WEAR-29556388



SPECIFIED DIMENSIONS HAVE PRECEDENCE
OVER COMPUTER GENERATED DATA

CHANGE RESTRICTED

METRIC

THIRD ANGLE

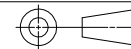

THE INFORMATION CONTAINED HEREIN IS PROPRIETARY AND THE
PROPERTY OF ALLISON TRANSMISSION, INC. AND MAY NOT BE
REPRODUCED, DISCLOSED OR USED FOR ANY PURPOSE OTHER THAN A
QUOTATION TO OR ON ORDER FROM ALLISON TRANSMISSION, INC.
WITHOUT THE SPECIFIC WRITTEN AUTHORIZATION OF
ALLISON TRANSMISSION, INC.

REV	DESCRIPTION	DATE	BY
REVISIONS			
DRAWN R. HIGGINS			
DATE 11JL14			
CHECKED A. SOWDERS			
DATE 06AUI4			
APPROVED			
DATE 06AUI4			
PROJ. ENGR. A. SOWDERS			
DATE 06AUI4			
APPL. ENGR. T. BROWN			
DATE 06AUI4			
ADAPTATION DRAWING-IVECO, CURSOR 9			
MODEL 4000 PRODUCT FAMILY			
SIZE D	CAGE CODE 73342	DWG NO	AS04-535
SCALE NONE			
CURRENT STATUS: RX-Released - EXP			
SHEET ---			

AS04-535